



# MARTIAL COTTLE PARK



## LEGEND

- |                  |  |  |   |
|------------------|--|--|---|
|                  | Ranger Station/Visitor Center<br>Phone: (408) 355-2299 |  | Paved Road                                      |
|                  | Entry Kiosk & Pay Station                              |  | Park Road (Bicycles OK)                         |
|                  | Parking  |  | Service Road (No Public Access)                 |
|                  | Gate   |  | Trail Distance (miles)                          |
|                  | Restrooms  |  | Creek   |
|                  | Picnic Area  |  | Private Property                                |
|                  | Reservable Group Picnic Area                           |  | Future Use Area (No Public Access)              |
|                  |  |  | Agriculture Area (Lessee & Invitee Access Only) |
| <b>TRAIL USE</b> |  |  |   |
|                  | Hiking   |  | Paved Hiking                                    |
|                  | Hiking/Equestrian/Bicycling                            |  | Paved Hiking/Equestrian/Bicycling               |

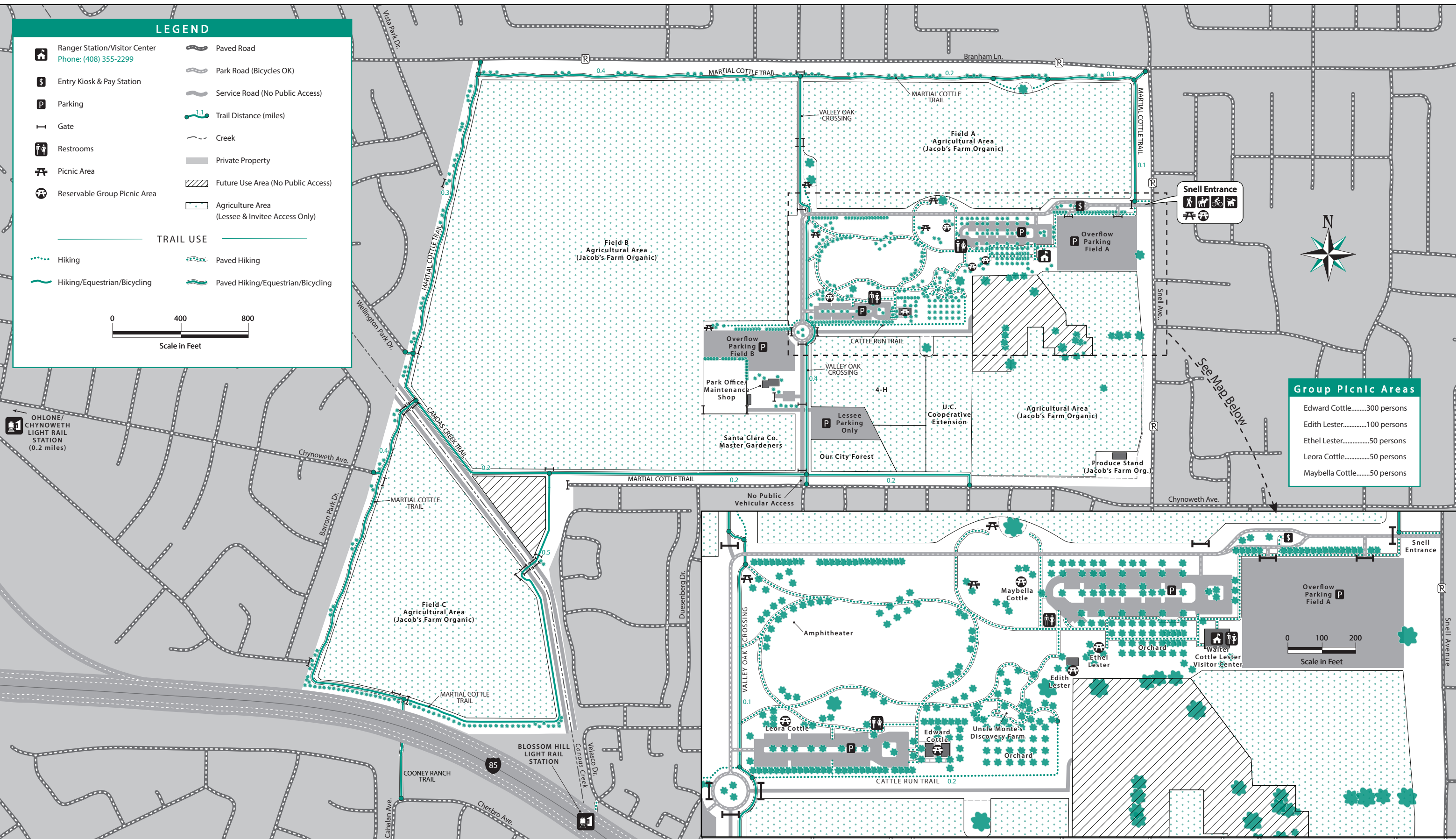
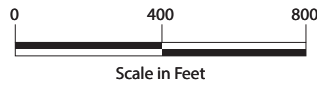

Group Picnic Areas	
Edward Cottle.....	300 persons
Edith Lester.....	100 persons
Ethel Lester.....	50 persons
Leora Cottle.....	50 persons
Maybella Cottle.....	50 persons

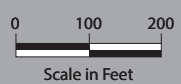

OHLONE/CHYNOWETH LIGHT RAIL STATION (0.2 miles)

BLOSSOM HILL LIGHT RAIL STATION

See Map Below