

# **SHEETS**

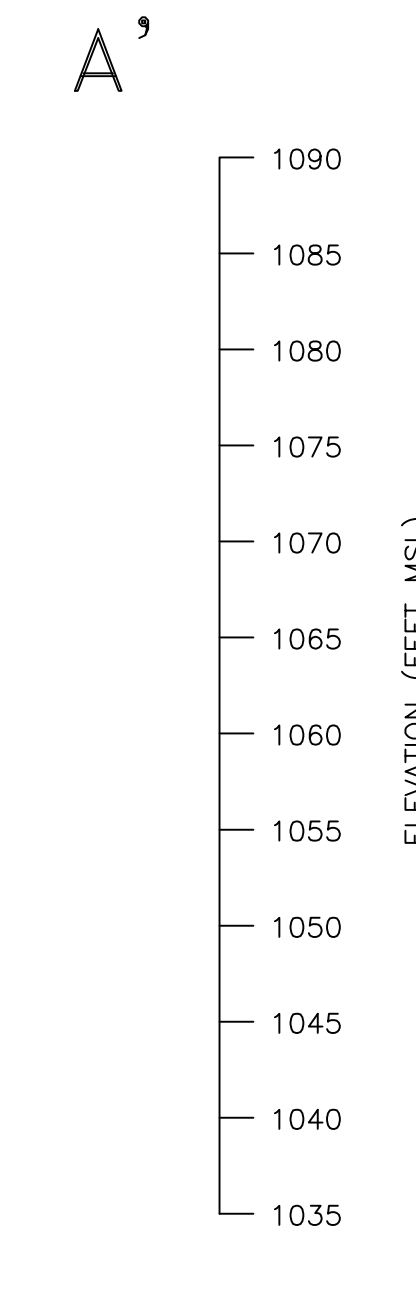
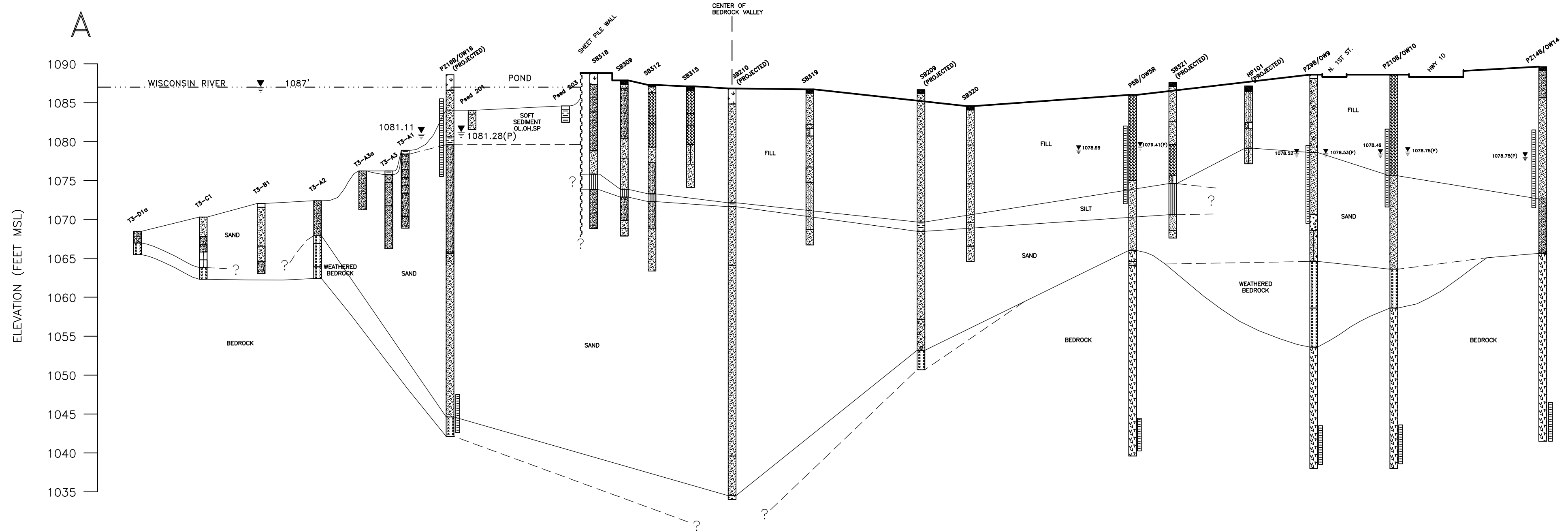

**LEGEND**

ORGANIC SILT WITH GRAVEL	POORLY-GRADED SAND WITH GRAVEL	SCREENED INTAKE
HIGH PLASTICITY ORGANIC SILT OR CLAY	WELL-GRADED GRAVELLY SAND	ND
POORLY-GRADED SAND WITH SILT	ELASTIC SILT	NOT DETECTED
POORLY-GRADED GRAVEL	TORSOL	NOT ANALYZED
POORLY-GRADED SAND WITH SILT AND GRAVEL	SALT	µg/L MICROGRAMS PER LITER
WELL-GRADED SAND	SALTY SAND	mg/L MILLIGRAMS PER LITER
POORLY-GRADED SAND	WEATHERED BEDROCK	EXCEEDS NR 140 PREVENTIVE ACTION LIMIT
ASPHALT	BOUNDARY SAND	EXCEEDS NR 140 ENFORCEMENT STANDARDS
WELL-GRADED SAND WITH SILT	GRANITE	WATER TABLE ELEVATION 11/71/02
		PREVIOUS WATER LEVEL 07/19/07
		PREVIOUS WATER LEVEL 07/19/07

NOTES:  
 1. PORTIONS OF CROSS SECTION BASED ON PREVIOUS BORINGS AND CHANGES TO 3075-010 BY SIMON HYDRO-SEARCH DATED 11/9/02 WITH INTERPRETATION BY NRT.  
 2. BEDROCK BORING FOR INSTALLED BY SIMON HYDRO-SEARCH USING WATER ROTARY METHOD WITH FRACTURE ZONES AS NOTED. BEDROCK BORINGS PZ-78, PZ-98, PZ-108 AND PZ-118 INSTALLED BY NRT USING SONIC METHOD AND CORE SAMPLING WITH FRACURES AS NOTED.  
 3. CROSS SECTION REPRESENTS A GENERALIZED INTERPRETATION OF SUBSURFACE CONDITIONS. STRATUM LINES ARE BASED ON INTERPOLATION BETWEEN BORINGS AND MAY NOT REPRESENT ACTUAL SUBSURFACE CONDITIONS. FOR A DETAILED DESCRIPTION OF INDIVIDUAL BORINGS, REFER TO SOIL BORING LOGS IN PREVIOUS REPORTS.  
 4. GROUNDWATER ELEVATIONS SHOWN ARE APPROXIMATE BASED ON MEASUREMENTS BY NRT.

VERTICAL SCALE IN FEET = 10  
 HORIZONTAL SCALE IN FEET = 80  
 VERTICAL EXAGGERATION = 8

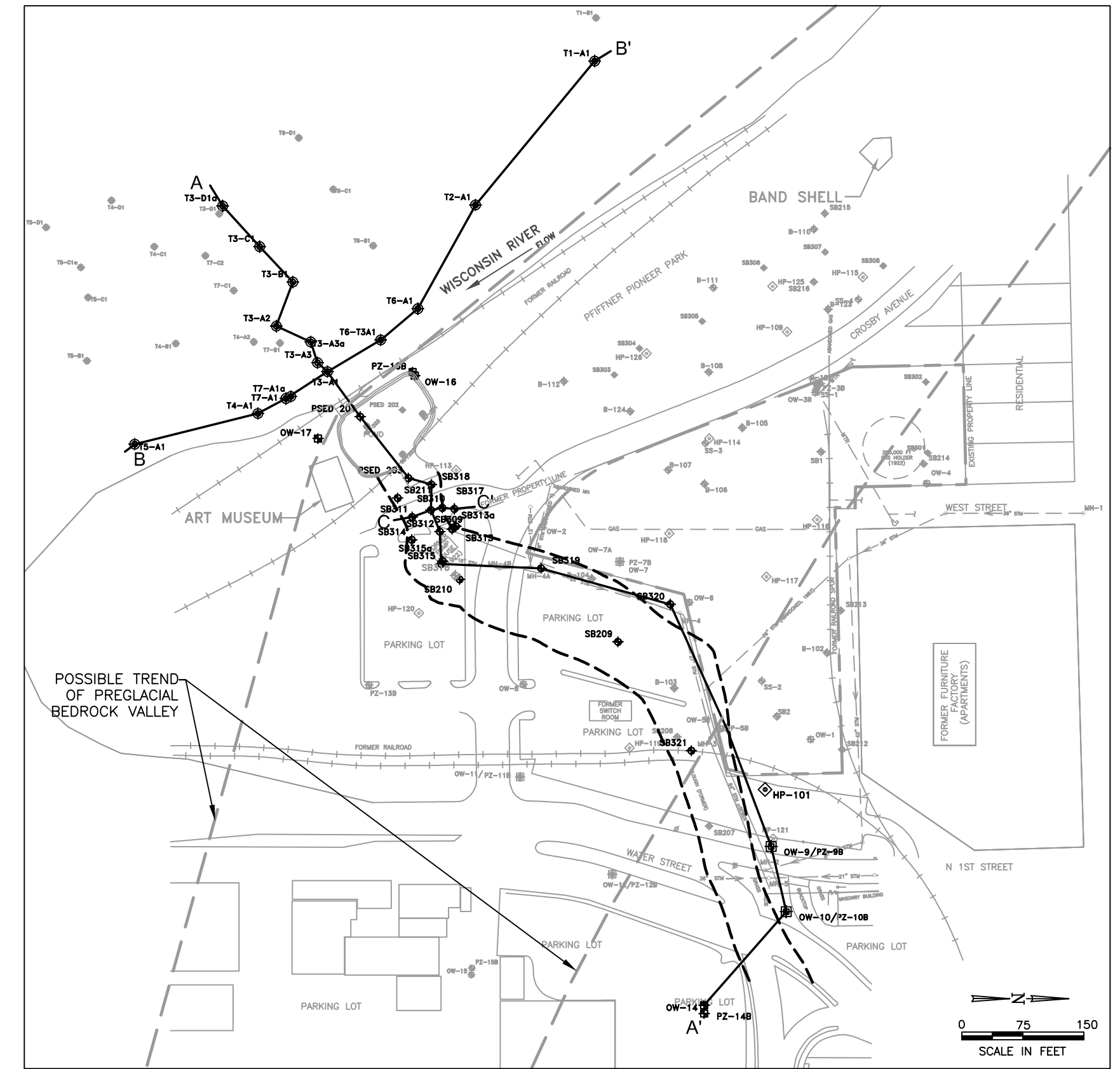
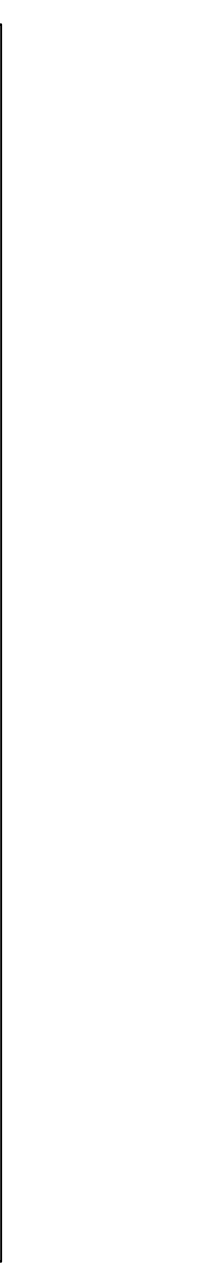
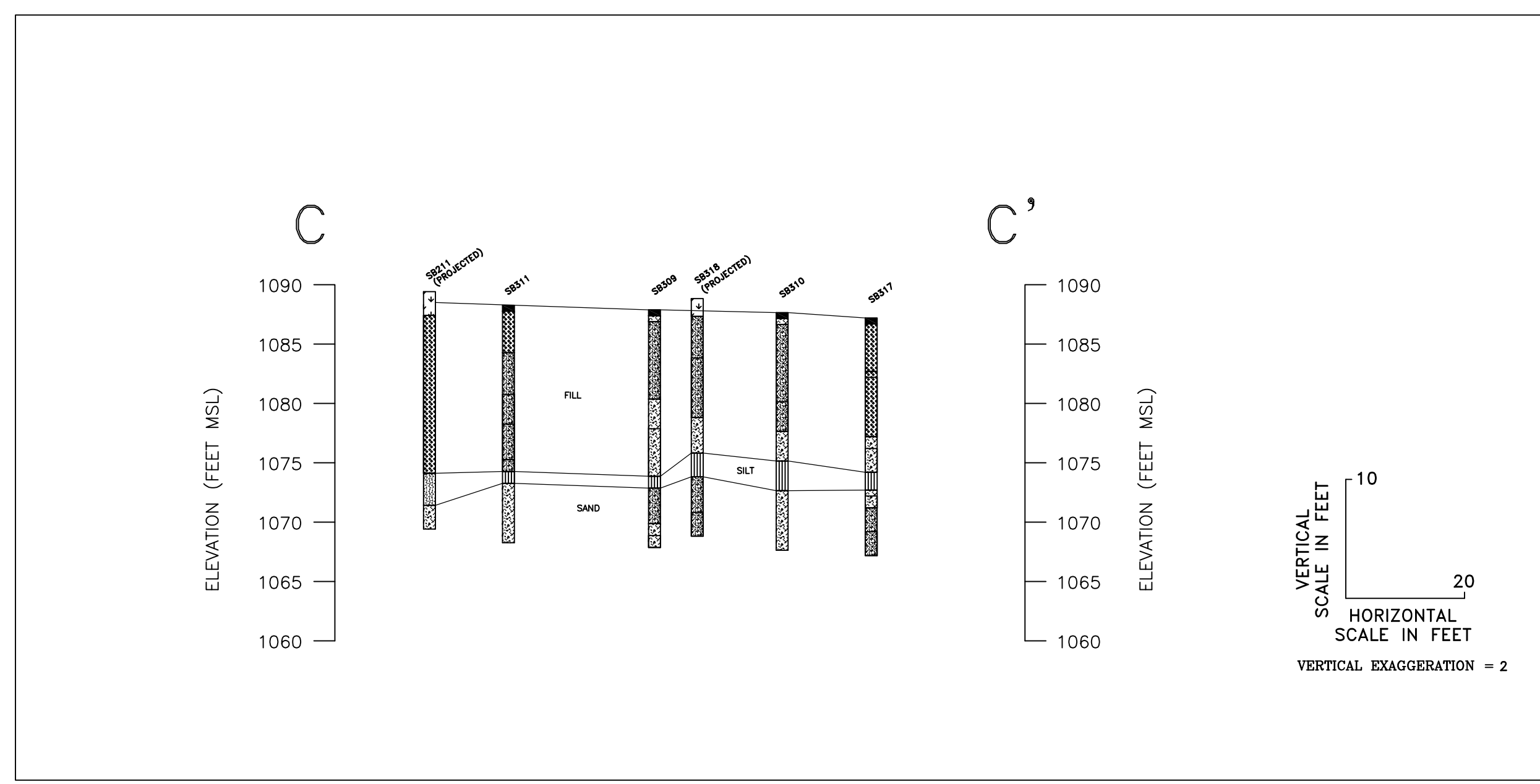
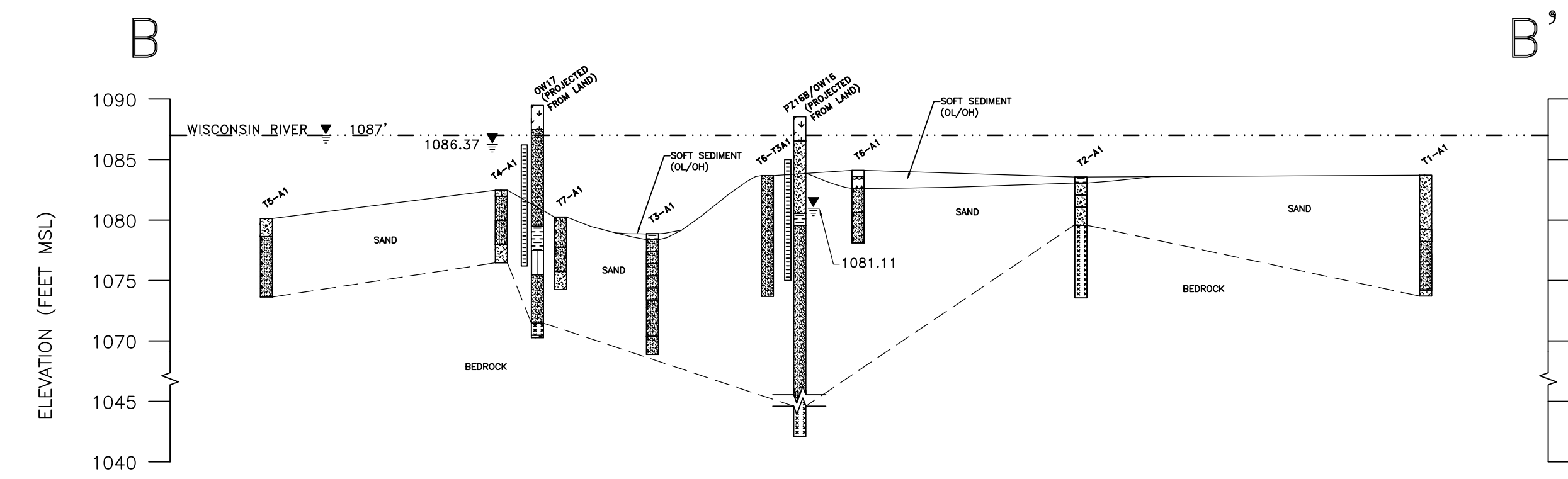

**NATURAL RESOURCE TECHNOLOGY**

**PROJECT NO. 1177/14.12**

**DRAWN BY: RLH 05/28/08**

**CHECKED BY: EPK 05/30/08**

**APPROVED BY: JMK 06/04/08**

**GEOLOGIC CROSS SECTIONS**

**REMEDIAL INVESTIGATION REPORT**  
**WISCONSIN PUBLIC SERVICE CORPORATION**  
**FORMER MANUFACTURED GAS PLANT, STEVENS POINT, WISCONSIN**

PROJECT NO. 1177-1412-D01  
 SHEET NO. 1

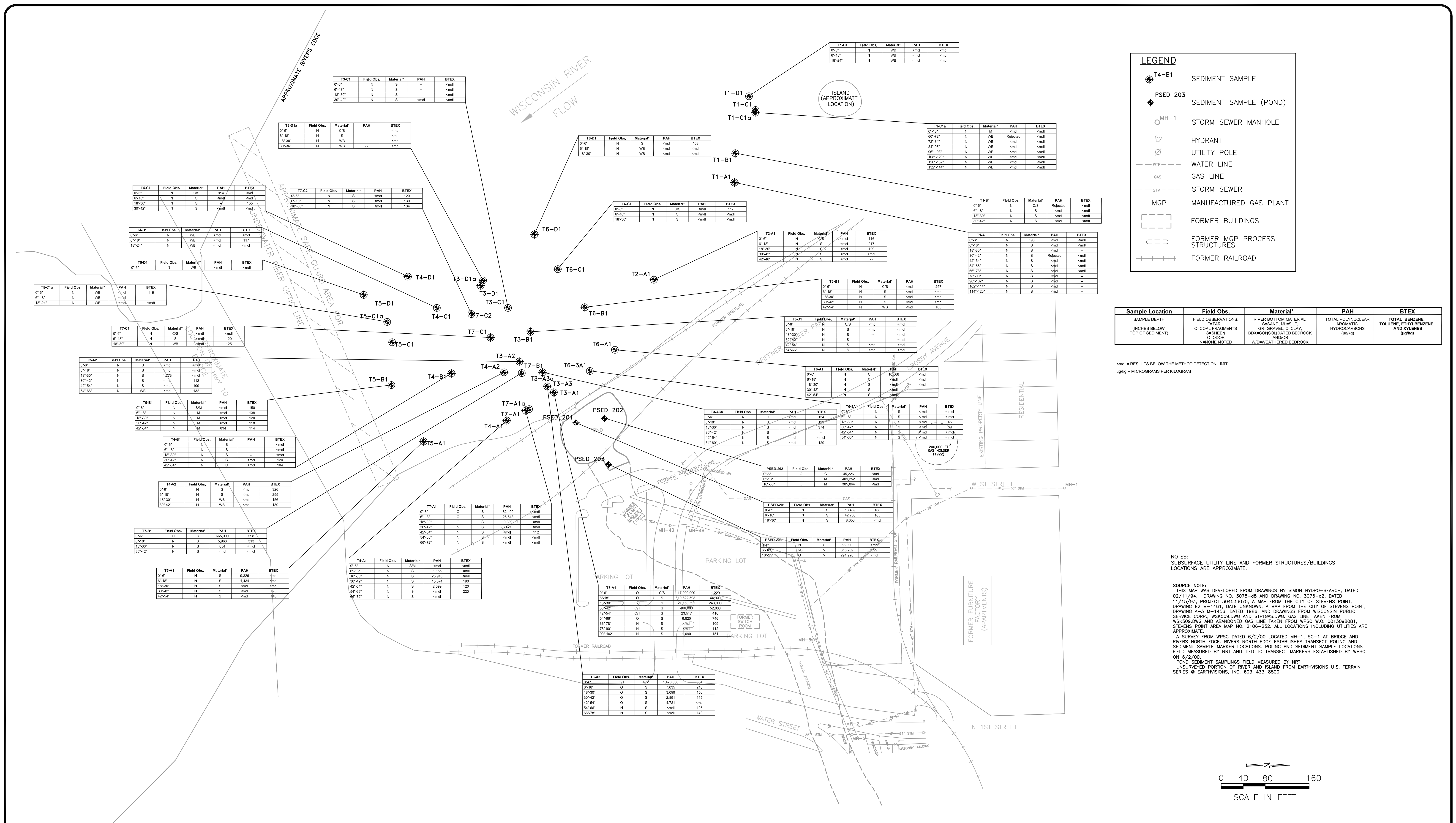

**LEGEND**

- T4-B1 SEDIMENT SAMPLE
- PSED 203 SEDIMENT SAMPLE (POND)
- MH-1 STORM SEWER MANHOLE
- HYDRANT
- UTILITY POLE
- WATER LINE
- GAS LINE
- STORM SEWER
- MANUFACTURED GAS PLANT
- FORMER BUILDINGS
- FORMER MGP PROCESS STRUCTURES
- FORMER RAILROAD

Sample Location	Field Obs.	Material*	PAH	BTEX
SAMPLE DEPTH (INCHES BELOW TOP OF SEDIMENT)	FIELD OBSERVATIONS: T4/T4B CHOCAL FRAGMENTS CHOCODR N/NOISE NOTED	RIVER BOTTOM MATERIAL: S=SAND, M=MUD, G=GRAVEL, C=CAYL, B=BOX/CONSOLIDATED BEDROCK, AND/OR W=WEATHERED BEDROCK	TOTAL POLYNUCLEAR AROMATIC HYDROCARBONS (µg/kg)	TOTAL BENZENE, TOLUENE, ETHYLBENZENE, AND XYLENES (µg/kg)

<md = RESULTS BELOW THE METHOD DETECTION LIMIT  
µg/kg = MICROGRAMS PER KILOGRAM

**NOTES:**  
SUBSURFACE UTILITY LINE AND FORMER STRUCTURES/BUILDINGS LOCATIONS ARE APPROXIMATE.

**SOURCE NOTE:**  
THIS MAP WAS DEVELOPED FROM DRAWINGS BY SIMON HYDRO-SEARCH, DATED 02/11/94, DRAWING NO. 3075-48 AND DRAWING NO. 3075-42, DATED 11/15/93, PROJECT 304533075, A MAP FROM THE CITY OF STEVENS POINT, DRAWING E2 M-1461, DATE UNKNOWN, A MAP FROM THE CITY OF STEVENS POINT, DRAWING A-3 M-1456, DATED 1986, AND DRAWINGS FROM WISCONSIN PUBLIC SERVICE CORP., WSK509.DWG AND STRIGAS.DWG. GAS LINE TAKEN FROM WSK509.DWG AND ABANDONED GAS LINE TAKEN FROM WPSIC W.D. 001308081. STEVENS POINT AREA MAP NO. 2106-252. ALL LOCATIONS INCLUDING UTILITIES ARE APPROXIMATE.

A SURVEY FROM WPSIC DATED 6/2/00 LOCATED MH-1, SG-1 AT BRIDGE AND RIVERS NORTH EDGE. RIVERS NORTH EDGE ESTABLISHES TRANSECT POLING AND SEDIMENT SAMPLE MARKER LOCATIONS. POLING AND SEDIMENT SAMPLE LOCATIONS FIELD MEASURED BY NRT AND TIED TO TRANSECT MARKERS ESTABLISHED BY WPSIC ON 6/2/00.

POND SEDIMENT SAMPLINGS FIELD MEASURED BY NRT. UNSURVEYED PORTION OF RIVER AND ISLAND FROM EARTHVISIONS U.S. TERRAIN SERIES © EARTHVISIONS, INC. 603-433-8500.

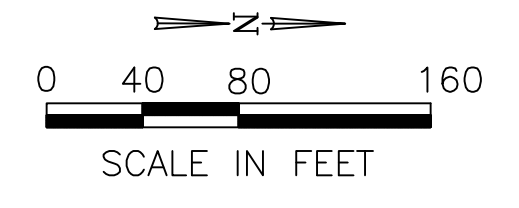

	PROJECT NO. 1177/14.12	<p><b>SEDIMENT ORGANIC ANALYTICAL SUMMARY</b></p> <p>REMEDIAL INVESTIGATION REPORT WISCONSIN PUBLIC SERVICE CORPORATION FORMER MANUFACTURED GAS PLANT, STEVENS POINT, WISCONSIN</p>	SHEET NO. 2
	DRAWN BY: RLH 06/02/08		
	CHECKED BY: EPK 06/02/08		
	APPROVED BY: JMK 06/04/08		